



Zip On, Flip Up

Zip Hinge™ Installation Instructions

Optional Zip Hinge™ Clasp Installation Instructions

TOOLS REQUIRED: Tin Snips, 8 Zip Screws, 1/4" Hex Bit and a Drill

TOOLS REQUIRED: 1 Zip Screw, 1/4" Hex Bit, Drill or 1/8" Rivet and Rivet Gun

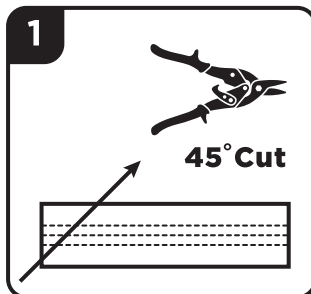

Using tin snips, cut out a 45 degree angled section of the downspout extension.

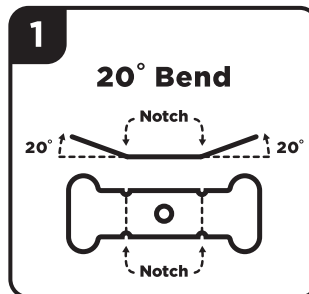

Bend clasp at notches to approximately 20 degrees.

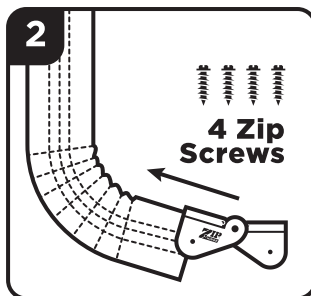

Slide the Zip Hinge onto the elbow of the down-spout and secure with zip screws. Make sure the Zip Hinge is fully seated before attaching.

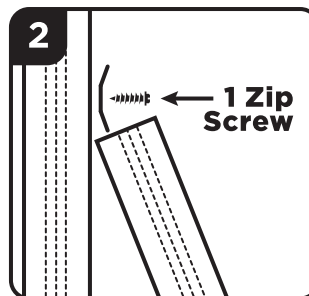

Use zip screw or 1/8" rivet to attach clasp 3/4 inches above raised extension.

*Zip screw is not included.

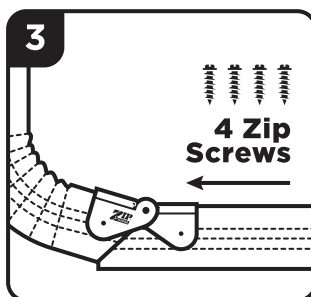

Slide the cut section of the downspout extension into the Zip Hinge and secure with zip screws. Make sure the down-spout is fully seated before attaching.

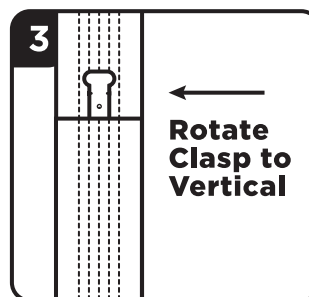

Rotate clasp to vertical position to hold extension upright.

*Zip screw is not included.



Gutter Products

3636 N. 222nd Street
Elkhorn, NE 68022
(402) 289-2700
www.ziphinge.com



ALWAYS WEAR
SAFETY GLOVES



ALWAYS WEAR
SAFETY GLASSES



INSTALLS IN
1 MINUTE



PATENTS
PENDING

MADE
IN THE
USA